

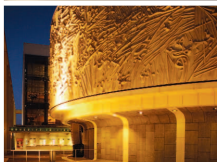

MUSIC CENTER



# PARKING ALERT FOR MUSIC CENTER PATRONS

Beginning on July 12, 2010, access points into and out of the Music Center garage will be limited due to the start of construction of the new Civic Park, located directly across the street at the County Mall.

## ENTRY

Grand Avenue entry into the garage will be available via SOUTHBOUND traffic only. There will be NO northbound access (or left turn) into the garage.

## EXIT

Patrons parked on UPPER LEVELS will be directed to exit onto southbound GRAND AVENUE, right turn only.

Patrons parked on LOWER LEVELS will be directed to exit onto southbound HILL STREET, right turn only.

## FREEWAY ACCESS

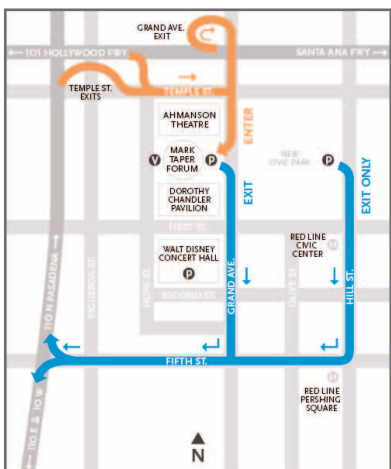

The 110 Freeway on-ramp located at 5th Street provides access to all major freeways (110, 10, 101, and 5) out of Downtown Los Angeles.

Based on the flow of traffic, it is **recommended that patrons use the freeway on-ramp at 5th Street.**

Southbound Grand Avenue and Hill Street lead to 5th Street, which runs westbound only.

For more information, call (213) 972-7211 or visit [musiccenter.org](http://musiccenter.org)

Photos: Walt Disney Concert Hall by Tom Bonner, Dorothy Chandler Pavilion by Neal McCharles, Ahmanson Theatre & Mark Taper Forum by Alex Pitt.

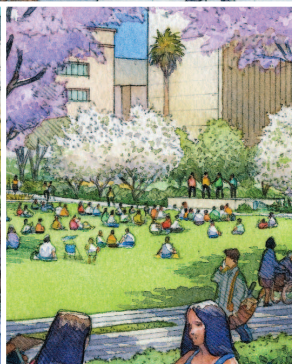

# CIVIC PARK

The new Civic Park, to be built on the County Mall and the Criminal Courts building parking lot, will extend from the Music Center to City Hall.

When finished in 2012, it will have four distinct levels featuring amenities including a **community terrace area** showcasing plants from around the world to a **restored historic Arthur J. Will Memorial fountain**, complete with a new wading membrane pool. There will also be a **performance lawn, grand event lawn, ADA-accessible walkways**, and an area for **chess players and dog run**.